

Installing flow control discs

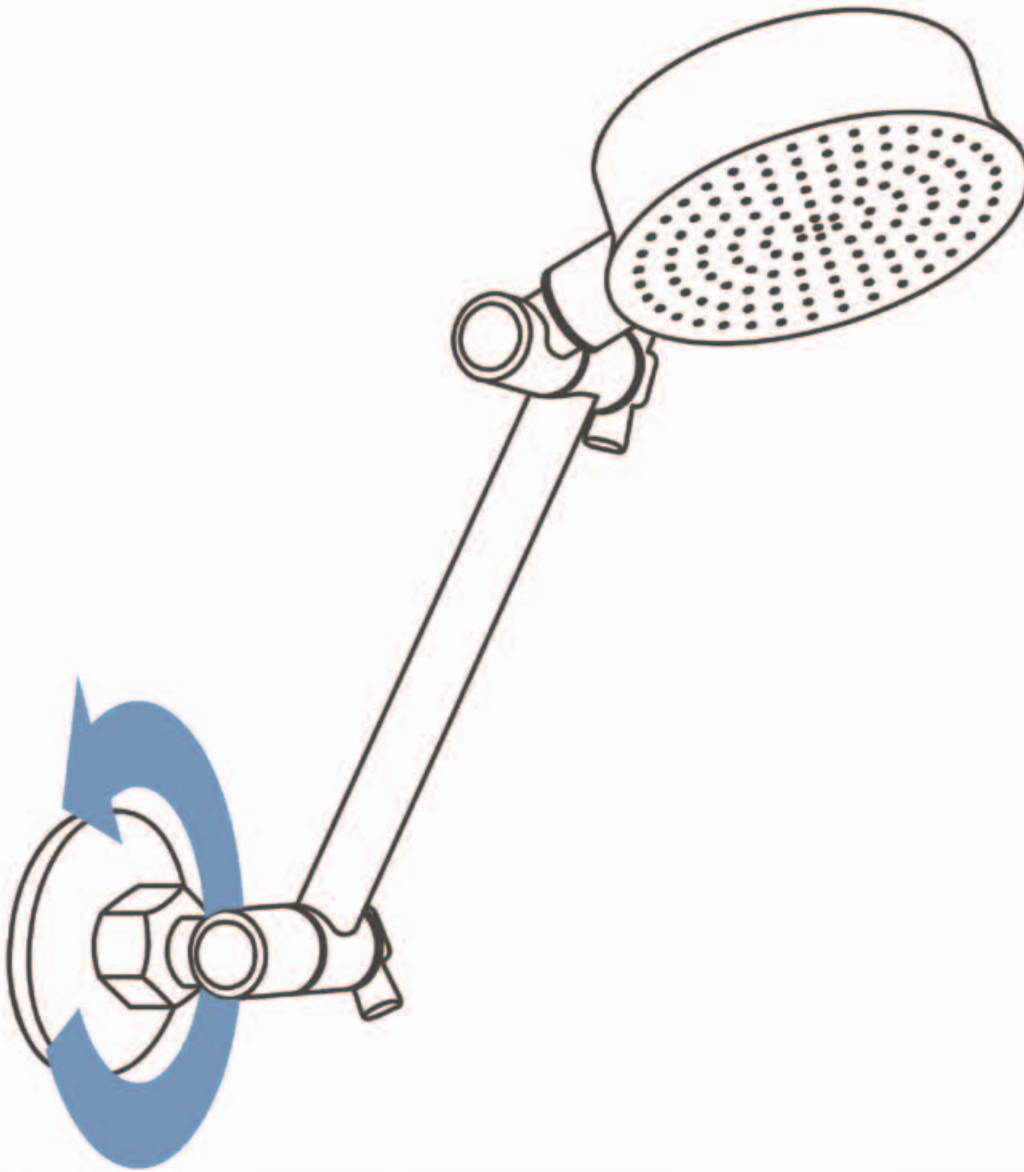

STEP 1

Unscrew the existing showerhead anti-clockwise.

Installing flow control discs

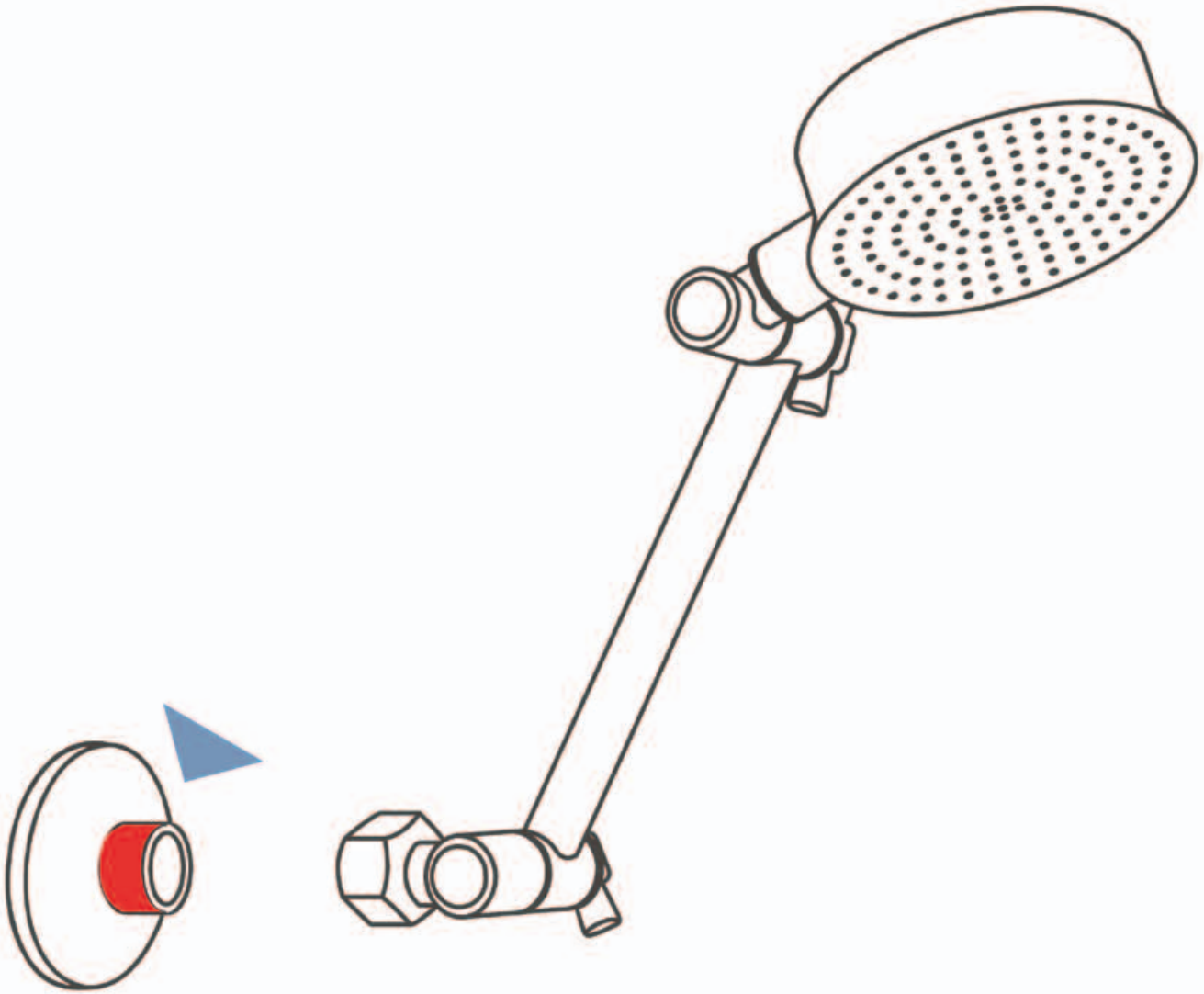

STEP 2

Clean the exposed thread and bind clockwise with thread sealing tape.

Installing flow control discs

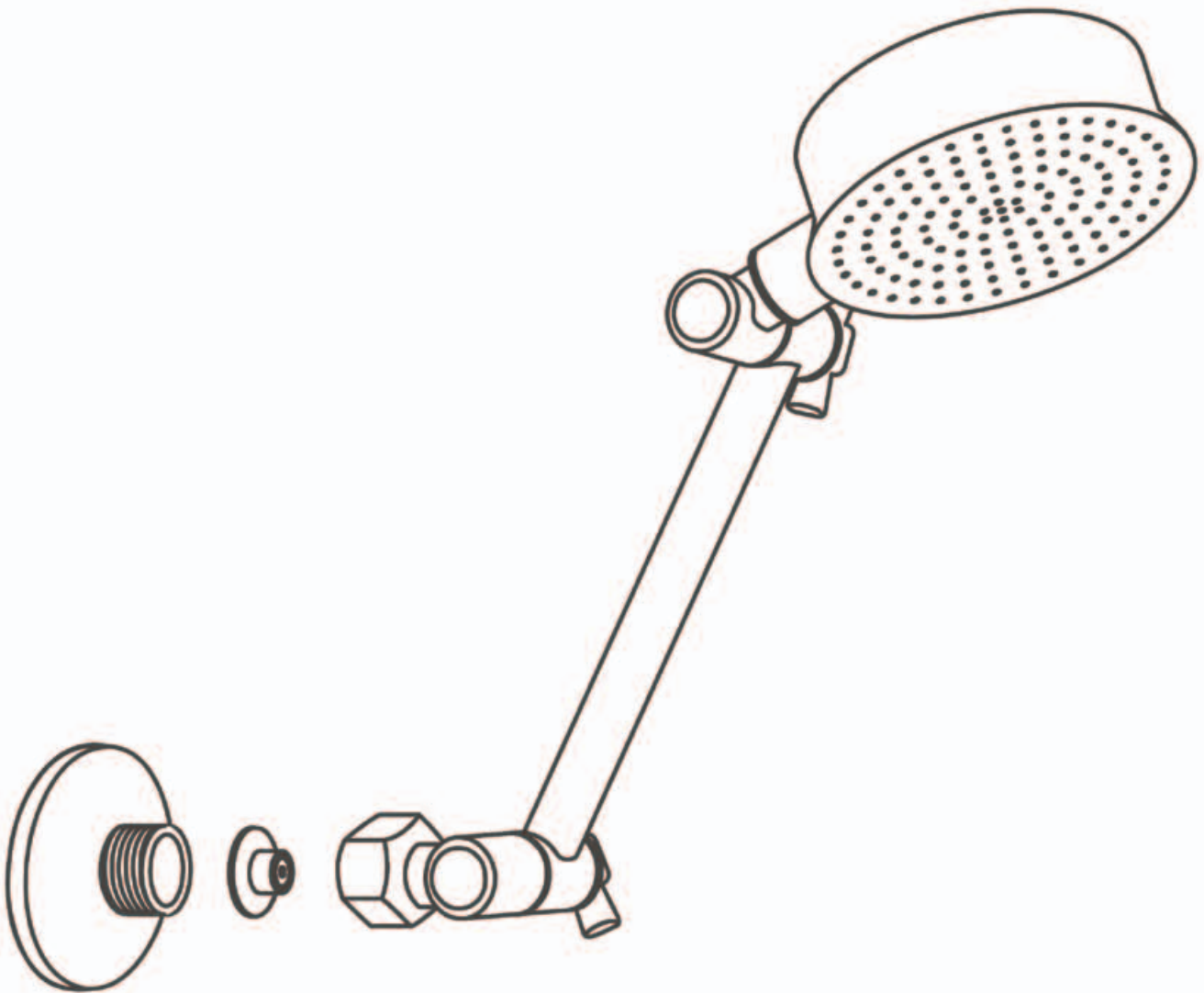

STEP 3

Install the Flow Control Disc with the wickets hat facing into the shower fitting.

Installing flow control discs

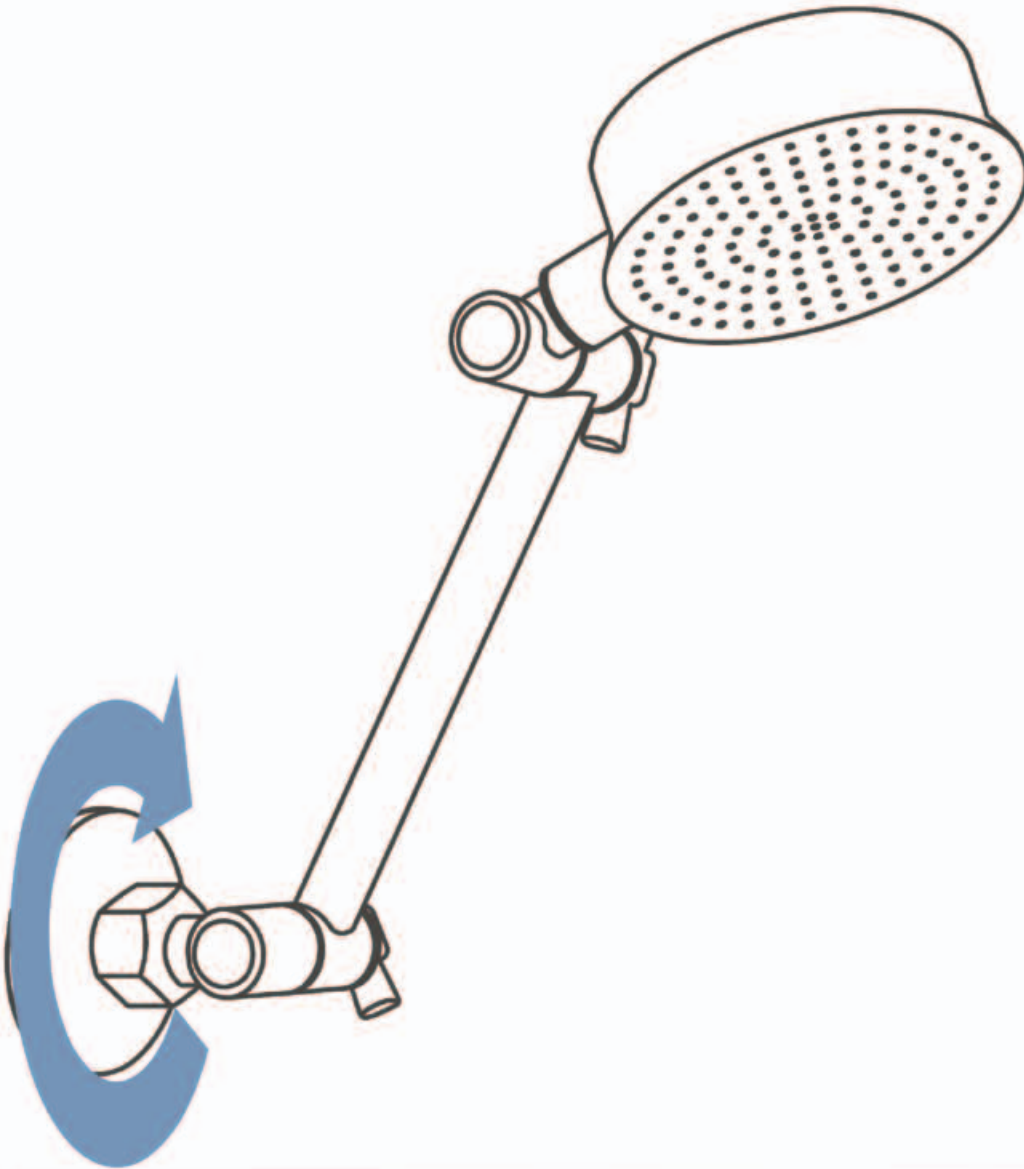

STEP 4

**Screw the fitting onto the thread making sure the thread is all the way home on the disc.
Do not over tighten as damage may occur.**